

# THANK YOU !!

The conference has been made possible thanks to our partners and sponsors:



This booklet was created by: Masae Ebersson, Front page design by Elena Walker, support from East Sweden Convention Bureau, Niclas Fock, Maria Holmkvist, Ondřej Ondryáš

# DFRWS 13th Annual Digital Forensics Research Conference 2026 EUROPE



24–27 March, 2026

## Linköping SWEDEN

To view calls for participation, submission guidelines and other event details visit [www.dfrws.org](http://www.dfrws.org)

DFRWS is a non-profit, volunteer organization dedicated to bringing together everyone with a legitimate interest in digital forensics to address the emerging challenges of our field. DFRWS organizes digital forensic conferences, challenges, and international collaboration to help drive the direction of research and development.

DFRWS conferences provide a friendly atmosphere to share research papers, practitioner presentations, and works in progress. Every gathering includes technical workshops, demos, panels, and other "breakout sessions" covering various issues related to digital forensics fostering transdisciplinary approaches to address emerging challenges in digital forensics by bringing together innovative researchers, developers, and practitioners from around the globe.

In Cooperation with



# Welcome to Linköping & Norrköping

Linköping and Norrköping are two vibrant cities in Sweden's Östergötland region, together forming the country's fourth-largest metropolitan area. Both cities host campuses of **Linköping University (LiU)**, which celebrated its 50th anniversary last year.

**Linköping** is a lively student and technology town with a strong focus on innovation and research. The city is also famous for its historic **Gothic cathedral** and the charming open-air museum **Gamla Linköping**, showcasing traditional wooden houses and life from past centuries. It also has a rich aviation heritage, and serves as the main hub for the **National Forensic Centre (NFC)**, a leading center for forensic investigation and research.

**Norrköping**, historically an industrial center, now blends cultural attractions with modern **digital visualization and interactive exhibitions**, offering visitors engaging experiences with data, simulations, and immersive technology. The nearby **Motala Ström river** is famous for salmon and trout swimming upstream, which can be observed in spring. Both cities are connected to the scenic **Göta Canal**, ideal for boat trips or cycling along its peaceful banks. In March and April, the region begins to awaken from winter, with crisp air and the first blooms of snowdrops, crocuses, and other beautiful flowers across forests and countryside.

## Practical Information

- Emergency phone number: **112** (ambulance, fire, police)
- Drinking water: Tap water is safe to drink and free in restaurants.
- Weather: Expect cool mornings and evenings—dress in layers for comfort.

## Swedes

Swedes are generally known for practical, polite, and punctual. They tend to be reserved with strangers, but once you get to know them, they are friendly and willing to help. They have a dry, subtle sense of humor and often appreciate irony. They value family life, enjoy spending time outdoors, and often use vacations to explore nature, relax by lakes, or travel.

## Currency, payments, ATMs

- **Currency:** Swedish Krona (SEK). 1 EUR ≈ 12 SEK (subject to change. Coins: 1, 2, 5, 10 kr. Notes: 20, 50, 100, 200, 500, 1000 kr. No Euro or US dollar are accepted in shops.
- **Cards:** Credit/debit cards are widely accepted and many places are even **card-only**.
- When paying by card, recommend to select to pay in SEK, not in your home currency.
- **ATM:** Hard to find, Sweden is a mostly cash-free society and very few people use cash.

## English in Sweden

In Sweden, English is taught from an early age in schools, and most Swedes, young and old, understand and speak it well. Exposure to English-language music, films, and media is widespread, and Swedes are generally happy to speak English with foreigners.

## Basic Swedish vocabulary

English 	Swedish 	Pronunciation
Hello / Hi	Hej /Tjena	hey /shen-na
How are you?	Hur mår du?	hoor mor doo
How's it going?	Hur är läget?	hoor air lay-get
Goodbye	Hej då	hey daw
Thank you	Tack	tak
Yes	Ja	yah
No	Nej	nay
Excuse me	Ursäkta	ur-shek-ta
I don't understand	Jag förstår inte	yah fur-stor in-teh
Do you speak English?	Pratar du engelska?	prah-tar doo eng-els-ka
Where is ...?	Var är ...?	var air
Cathedral	Domkyrka	DOHM-kyur-ka
Bathroom	Toalett	too-ah-let
Bus	Buss	boose
Train	Tåg	tohg
Ticket	Biljett	bil-yet
Restaurant	Restaurang	reh-sto-rang
The bill, please	Notan, tack	noo-tan, tack
Water	Vatten	vat-ten
Wine	Vin	veen
Meeting	Möte	mur-teh
Beer	Öl	euhl
Help!	Hjälp!	yelp

# Arriving in Linköping

## By plane

### [Linköping City Airport \(LPI\):](#)

Direct flights to/from Amsterdam Schiphol Airport (AMS) with KLM.

From the airport: Taxi: 10-15 min to Linköping University. Public bus (1 transfer) : 35-50 min

### [Stockholm Arlanda Airport \(ARN\)](#)

Airport near Stockholm. Direct flights to/from most European & intercontinental destinations.

From the airport to Stockholm central station: [Arlanda Express train](#) (18 min).

Then take a [SJ train](#) (X2000 or SJ Intercity, approx. 2 hours) from Stockholm central to Linköping central: Alternatively, [FlixBus](#) or [Vy](#) takes about 2h 50 min.

### [Skavsta Airport \(NYO\)](#)

Located in Nyköping, a town between Stockholm and Norrköping with Wizz Air and Norwegian. Use an airport bus ([Flygbuss](#)) that will take you to Linköping in about 90 minutes. From Norrköping to Skavsta airport is about 1 hour.

## From Copenhagen/Malmö/Gothenburg by train or bus

Train: [SJ train](#) or [Öresundståg](#) from Copenhagen/Malmö/Gothenburg ~ 4–6 h.

Bus: [FlixBus](#) or [Vy](#) ~6–10 h, usually 1 transfer.

## By car (Parking information)

Parking near A-House (Linköping University)

- 📍 Hans Meijers väg 13-15, or Olaus Magnus väg
- Paid parking: ~ 3SEK/h, ~ 20SEK/day.
- Pay at machines (cards) or via [Aimo Park app](#).
- More info & map: [aimopark.se](http://aimopark.se)

# Leaving from Norrköping on Friday

DFRWS provides complimentary bus from [Norrköping venue](#) on Friday 27<sup>th</sup> to Norrköping Central Station or Linköping city center. (depending on the number of participants needing the bus- please contact staff at reception/registration desk.

To Stockholm Central Station

Take a [SJ train](#) (X2000 or SJ Intercity, approx. 1.5h) from Norrköping Central Station to Stockholm: Alternatively, [FlixBus](#) or [Vy](#) takes about 2 hours from Norrköping central station to Stockholm central station. You can easily travel other main cities from Norrköping.



△ Old Town, Linköping

▽ Kinda Canal



# Getting around Linköping

## Local Transport:

Buses are run by Östgötatrafiken and it's cash-free – pay by [credit card](#) or Östgötatrafiken app (QR codes on the right, highly recommended). You can check timetables, plan trips, and buy tickets in advance via the app.



Apple



Google Play

## Towards the conference venue (Linköping University)

From Linköping Central Station (Resecentrum), buses 12, 20, and 540 go to Linköping University. These buses stop at “**Universitetet, Linköping**”, which is close to our **A-building (A-huset)**. Bus 3 stops at Solhaga. Bus 4 stops at Nobeltorget, which requires a longer walk. We recommend that you check bus route-map with the App.

## Taxi (Uber works too)

- [Taxibil](#)- Book via webb, app or call +4613-14 60 00 or +4613-10 10 00
- [Gripen Taxi](#) Book via webb, app or call +4613-30 30 00

## Social Events & Activities

 **Welcome Reception:** Join us on Tuesday evening, 24<sup>th</sup> at **C-huset** (University Campus). located within 2 min walk from the main conference venue (see a map on the next page.)

 **Morning Run:** Join an easy run and explore Linköping's beautiful nature before the conference starts. Run leader on site.

 **Banquet, Awards ceremony & Rodeo:** Wednesday evening 25<sup>th</sup>. Enjoy a unique dinner experience surrounded by historic aircrafts at [Air Force Museum](#) .

DFRWS will provide **complimentary shuttle buses** from selected hotels. Please inform the staff at registration desk where your preferred pickup location is, so we can reserve a seat for you.



 **Thursday night on 26<sup>th</sup>:** It's a free night - but we have a meeting point at craft beer pub

- [De Klomp](#) 📍 [S:t Larsgatan 13](#), Linköping. Or, you can try these pubs below:
- Albert's Hall (Frimurare hotel) 📍 S:t Larsgatan 18.
- The Bishop's Arms 📍 Ågatan 27
- Ölstugan Tullen 1892 📍 Klostergatan 19E (Swedish Craft beer & Swedish food only)

To down town & Central train station (Resecentrum) 10-15 min by bus

## Map: Linköping University, Linköping

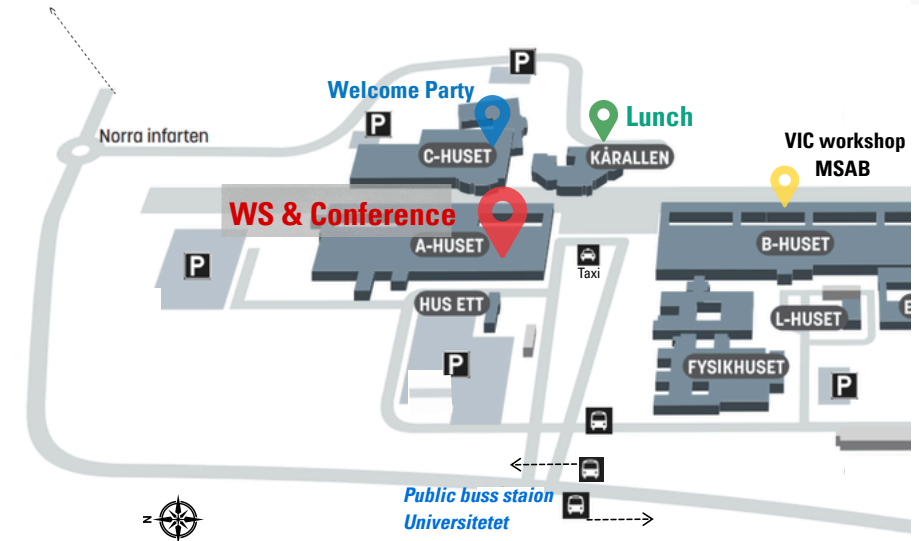

**A-building (A-huset):** WS and conference will be held in A-huset, Entrance 17.

**Kårallen:** Lunch restaurant - buffet

**C-building (C-huset):** The welcome Reception will be held on Tuesday evening.

All 3 buildings are located close to each other within a short walking distance.



Northern lights over A-huset

# Map of A-building (Ground floor)

## Floor Plan (Ground floor)

We have a reception desk at Agora square, coffees and entrance to A2 and ACAS. A1 is for WS on Tuesday afternoon.

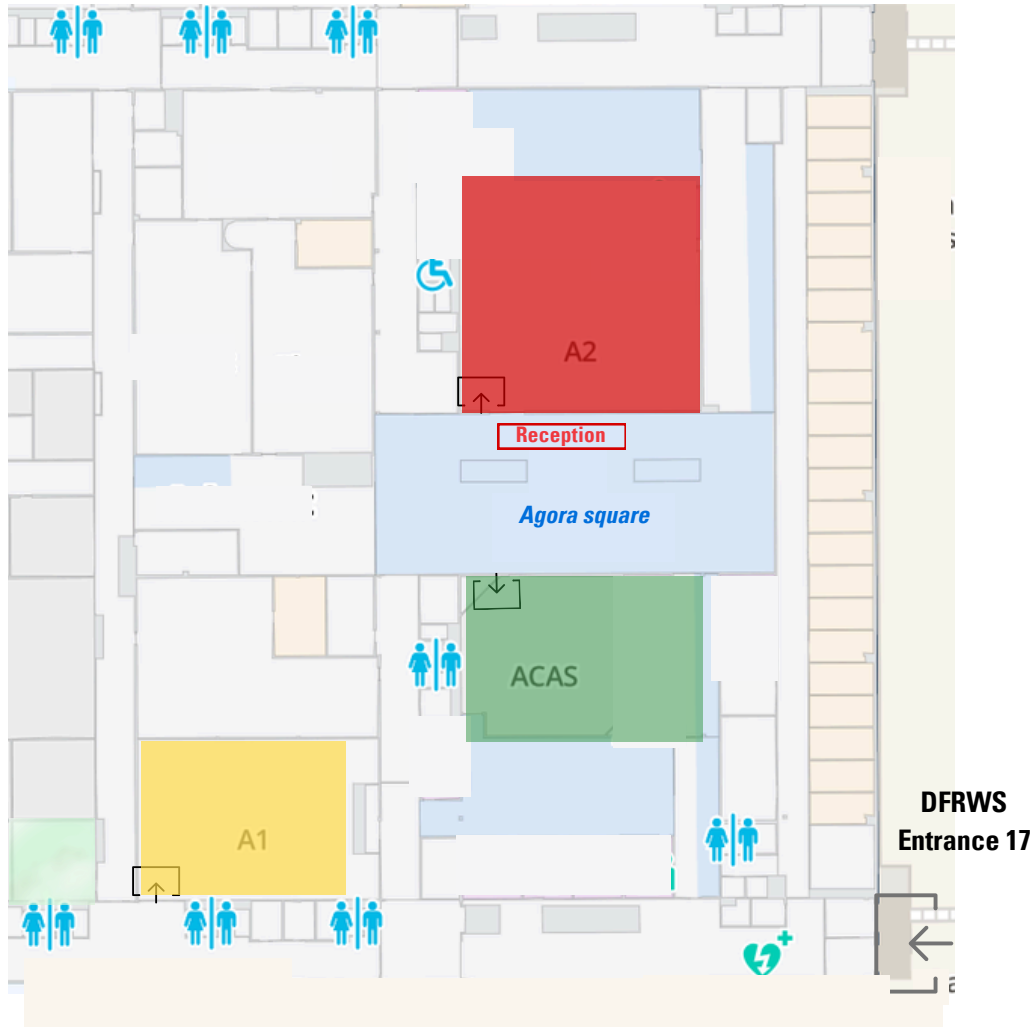

# Map of A-building (Upper floor)

## Floor Plan (Upper floor)

You can find posters and a room for WS (Parmberget) on the upper floor.

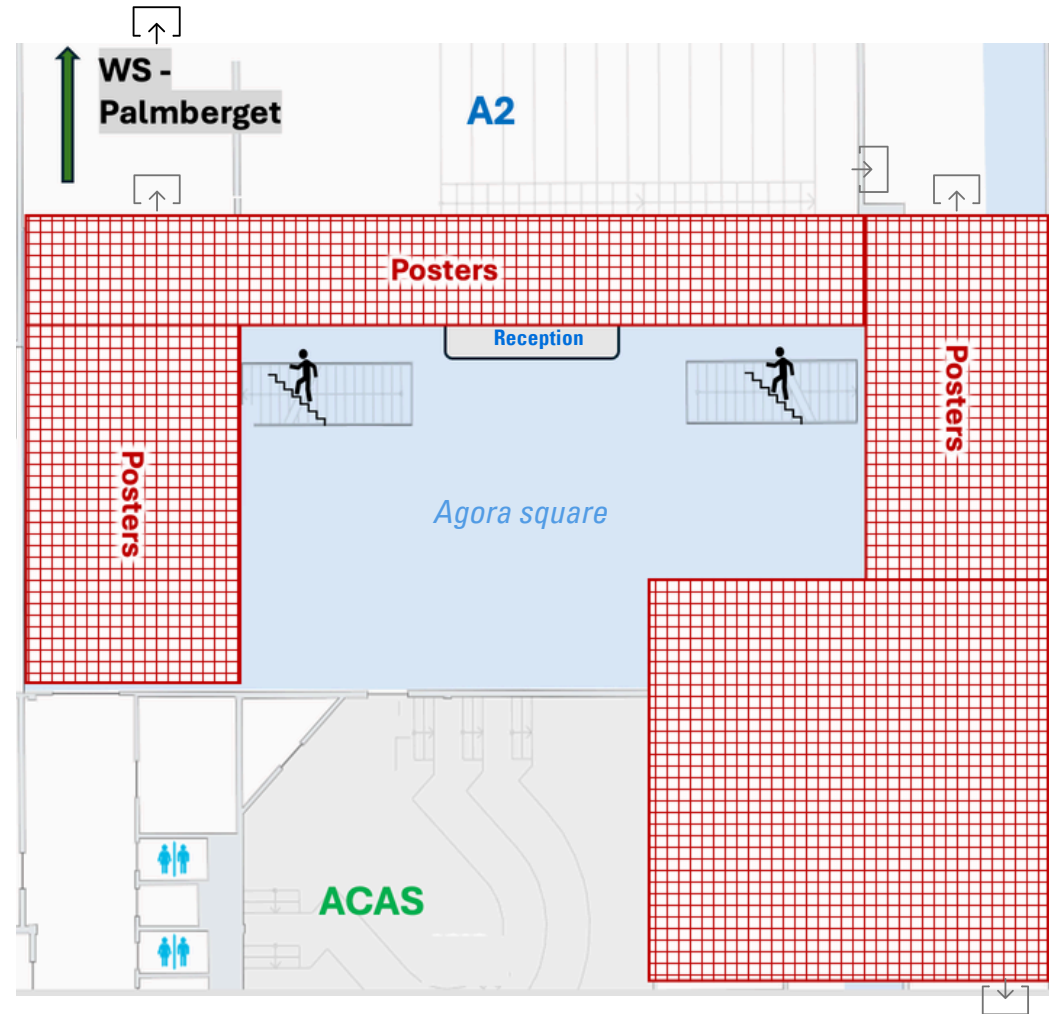

# Getting around Norrköping (Friday)

## Towards the Media Track venue (Cnema/VisualiseringscenterC)

DFRWS will provide **complimentary shuttle buses** from Linköping to Norrköping's venue  
Adress: *Kungsgatan 56, Norrköping*. Please inform the staff at the registration where your preferred pickup location is. Make sure to check out from the hotel on Friday morning and **bring your luggage with you** if you are leaving on Friday.

If you do not take DFRWS complimentary bus, there are local train and buses that goes from Linköping to Norrköping. From Norrköping Central Station, it is 15 min. walk or take a tram to a stop "Väster Tull". Alternatively take a bus 21 to "Skvallertorget" bus stop.

## Local Transport:

Trams and buses are run by Östgötatrafiken in Norrköping. Use the same App as Linköping. It's cash-free – pay by [credit card](#) or Östgötatrafiken app (QR codes on the right).



Apple



Google Play

## Parking

There are [municipal on-street parking](#) on the streets.  
[Bergskvadraten parking](#): is located at Kvarngatan 45  
[Spetsen parking garage](#): is located at Bredgatan 30

## Taxi (Uber works too)

[Sverige Taxi](#) Book via webb, app or call +4611-100 100



## Expedition: City Guided-walk in Norrköping on Friday March 27th

Places are limited to those who have pre-booked.  
The [City museum](#) & the [Labour museum](#) are located nearby, with free admission.



## Map: City centerr, Norrköping

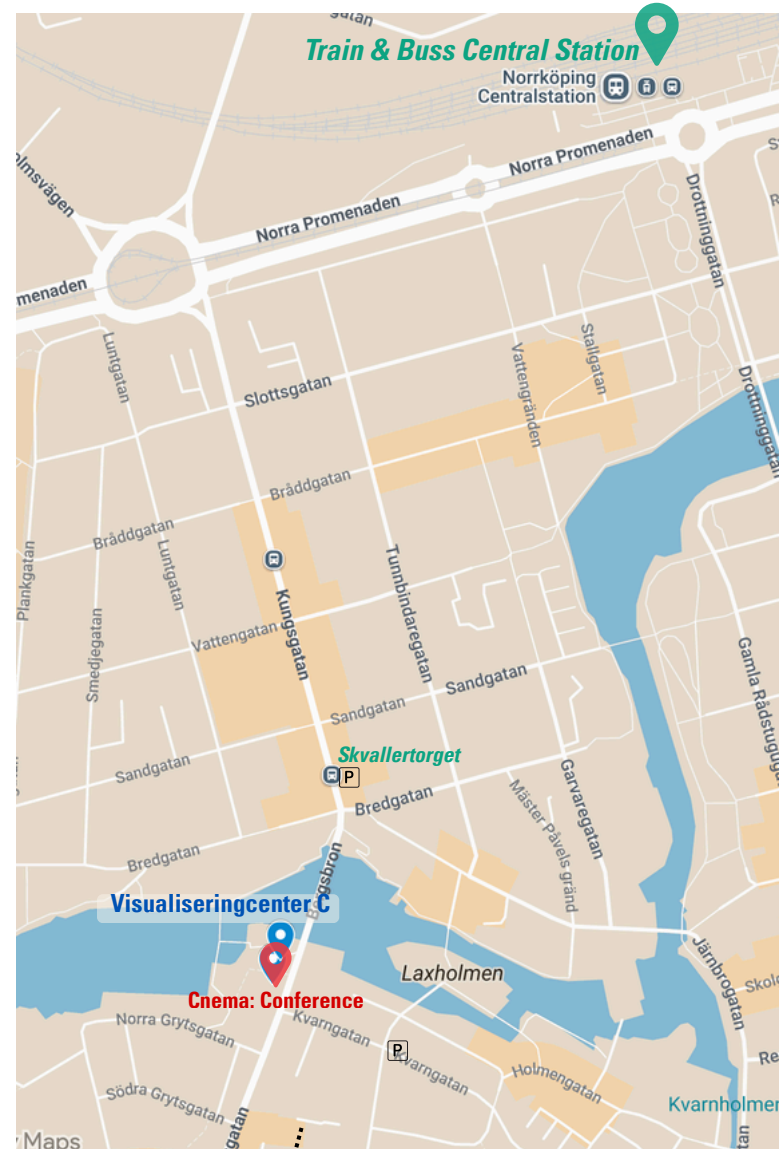

Local Tram & bus station: **Väster Tull**

**Media track sessions: Cnema** is located at *Kungsgatan 56, Norrköping*.

**Visualiseringscenter C:** Discover Forensics-related exhibitions such as *Visual Crime Scene*, *Inside Explorer*, *Human Organ Atlas*, and other exciting exhibition as well as amazing 3D-Dome journey to the science: *Chemistry of life*, *AI - an immersive journey into the future* etc. The lunch will be served at the restaurant.

# Spending time in Linköping/Norrköping

## Restaurants and pubs

Linköping and Norrköping offer a rich variety of restaurants and pubs covering both traditional and international cuisine. See Google reviews to find the best rating ones.

### Traditional Swedish Cuisine:

- Köttbullar – classic Swedish meatballs with creamy sauce, lingonberries, and potatoes.
- Gravad lax – cured salmon with dill, often served with mustard sauce and crispbread.
- Toast Skagen – classic Swedish seafood appetizer.
- Raggmunk – potato pancakes, sometimes served with fried pork or lingonberries.
- Smörgåsbord – traditional buffet with cold and hot dishes, especially famous for herring.
- Fika treats – pastries like kanelbulle (cinnamon bun), semla (cream-filled bun), or Prinsesstårta, enjoyed with coffee or tea.

### First food / quick bites:

- MAX Burgers – a Swedish burger chain offering meat, fish, and vegan options.

**Dietary tips:** Gluten-free, vegetarian, and vegan options are increasingly available.

## Fun facts - Linköping is a Craft beer hub

Linköping is a quiet favorite among craft-beer fans, with many bars focusing on Swedish microbreweries. Many cafés and bars are tucked away in inner courtyards—often easy to miss unless you know where to look. Cozy indoor seating and outdoor courtyards for smaller groups.

On our free night, **Thursday 26th**, we recommend to gather at:

1. **De Klomp.** Traditional Swedish food and selection of craft beers. 📍 **St Larsgatan 13**
2. Albert's Hall in Scandic Frimurare hotel – 📍 **St Larsgatan 18**
3. The Bishop's Arms – 📍 **Ågatan 27**
4. Ölstugan Tullen 1892 – 📍 **Klostergatan 19E** (Swedish Craft beer & Swedish food only)

## Tipping

In Sweden, VAT is already included in the price. Tipping is optional and never mandatory.

- How to tip: Since Sweden is cashless, you type the total amount you want to pay (bill + tip) into the card terminal yourself.
- Adding 5–10% or rounding up the bill (e.g., 920SEK → 1,000SEK) is common for dinner.
- When to skip: Tipping is not expected at lunch, in cafes, or when buying drink at the bar.
- If the service was just okay, it is perfectly fine to pay the exact amount.

# Spending time in Linköping/Norrköping

## Shopping

- Linköping: Stroll along **Drottninggatan and the surrounding pedestrian streets** in the city center for boutiques, cafés, and specialty shops. Galleriorna (shopping malls) like Gränden and Tornby offer a mix of international brands, groceries, and fashion.
- Norrköping: Visit **“Repslagaregatan” and the city center** for independent shops, cafés, and Swedish design stores. For food and drinks, supermarkets like ICA, Coop, Lidl, and Willys offer good quality at reasonable prices.

Look for local specialties, Scandinavian design, and cozy cafés while walking city streets. Most stores close by 6–8 PM; Sunday hours are limited.

## Fun facts -Norrköping

Drink by a waterfall: Few cities in Europe let you enjoy a beer or dinner right next to a roaring waterfall in the city centre.

▽ *A dramatic waterfall flowing through the heart of Norrköping.*

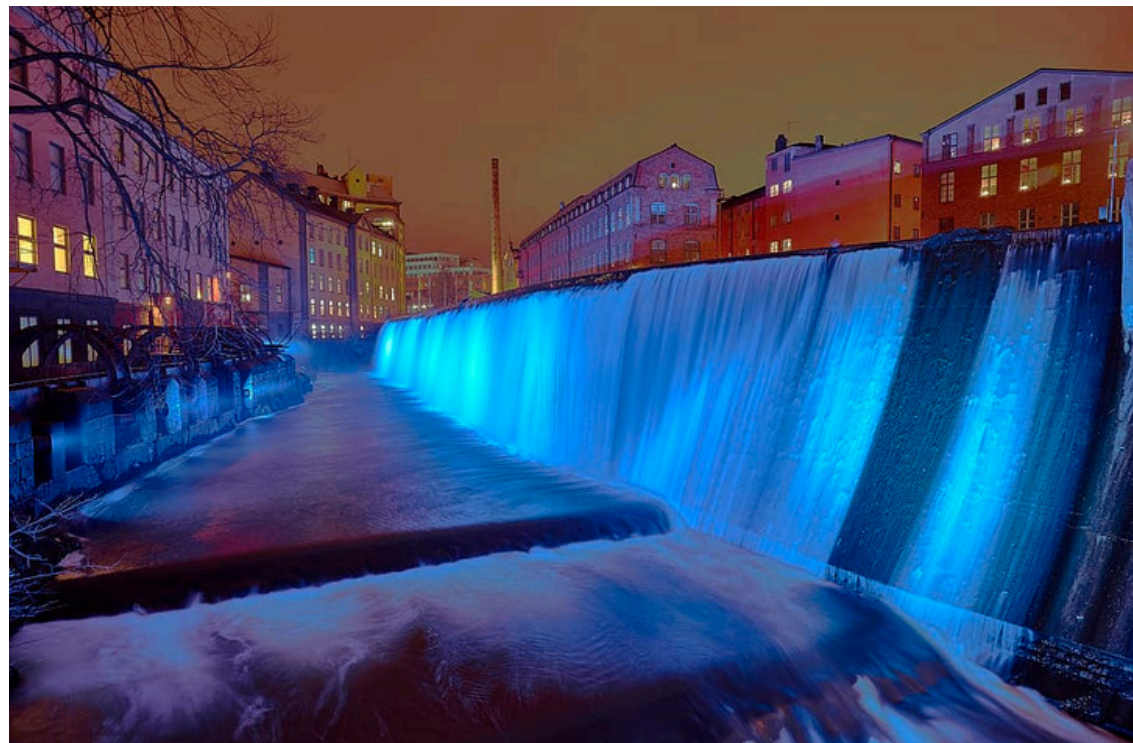

# Conference schedule overview

Find the latest schedule on <https://dfrws.org/eu-2026-program/>

## Tuesday, March 24

Tuesday is the workshop & DFDS (Digital Forensics Doctoral Symposium) day in **A1, A2, ACAS & Palmberget**. Note that the Palmberget is on the upper floor.

08:00 – 09:00	Registration	<b>📍 Agora, A-building, Linköping University</b>
09:00 – 10:45	Workshops + DFDS	
10:45 – 11:00	Coffee break	
11:00 – 12:45	Workshops + DFDS	
12:45 – 13:45	Lunch	
13:45 – 15:30	Workshops	
15:30 – 15:45	Coffee break	
15:45 – 17:30	Workshops	
18:00 – 20:30	<b>Welcome Reception</b>	<b>📍 C-building, Linköping University</b>

## Wednesday, March 25

The conference lectures are all held in **A2**. Posters are located on the upper floor.

08:00 – 09:00	Registration	<b>📍 Agora, A-building, Linköping University</b>
09:00 – 09:30	Welcome Address	
09:30 – 10:30	<b>Keynote</b>	
10:30 – 10:55	Paper Session I: Memory Forensics - Part I	
10:55 – 11:25	Coffee Break	
11:25 – 12:30	Paper Session I: Memory Forensics - Part II	
12:30 – 13:30	Lunch	
13:30 – 15:00	Paper Session II: Mobile Device Forensics	
15:00 – 15:30	Coffee Break	
15:30 – 16:45	Paper Session III: AI in Digital Forensics	
16:45 – 17:00	Lightning Talks & closing	<i>-back to your hotel and get ready for the banquet!</i>
18:30 – 19:00	Buss or own transfer to the venue	
19:00 – 23:00	<b>Banquet, Rodeo, Awards ceremony</b>	<b>📍 Air Force Museum</b>

## Thursday, March 26

The conference lectures are all held in **A2**. Posters are located on the upper floor.

08:00 – 09:00	Registration	<b>📍 Agora, A-building (A2), Linköping University</b>
09:00 – 10:00	<b>Keynote</b>	
10:00 – 10:30	Coffee break	
10:30 – 11:45	Paper Session IV: File Data Forensics	
11:45 – 12:30	Presentation Session II	
12:30 – 13:30	Lunch	
13:30 – 14:45	Paper Session V: Network and Emerging Forensics	
14:45 – 15:10	Short Presentation of Posters	
15:10 – 16:00	Coffee Break with Poster Session	
16:00 – 17:05	Paper Session VI: Forensic Tools & Evaluation	
17:05 – 17:15	Lightning talks	
17:15 – 17:30	Closing talk	

Free night

If you want to do networking, some of participants gather at **De Klomp**.

## Friday, March 27

We move the location to Norrköping city

08:00 – 08:40	Buss transfer to	<b>📍 Cnema/VisualiseringscenterC, Norrköping</b>
08:50 – 10:20	<b>Media Track</b>	
10:20 – 10:40	<b>Petra Lundh, National Police Commissioner, The Swedish Police Authority</b>	
10:40 – 11:00	Coffee break	
11:00 – 13:00	Explore exhibition: Visual Crime Scene, human organ atlas, Wisdome etc.	
13:00 – 14:00	Lunch, future DFRWS talk	
14:00 – 15:30	DFRWS Expedition (Norrköping guided tour)	



Find the latest schedule on the QR code



# DataExpert

DataExpert is a knowledge and technology partner in the fields of crime prevention, fraud prevention, and data security.

Through advanced software solutions, specialized training programs, and strategic consulting, DataExpert helps organizations analyze and address (digital) threats.

The company works closely with security services, government authorities, and commercial organizations at both national and international levels.

[www.dataexpert.eu](http://www.dataexpert.eu)

## Meet the Local Team

We are here to ensure that you have a great experience! Whether you have questions about the venue, lunch, banquet, complimentary buses, or simply want to know more about Linköping & Norrköping, please don't hesitate to reach out.



**Maria  
Holmkvist**



**Niclas  
Fock**

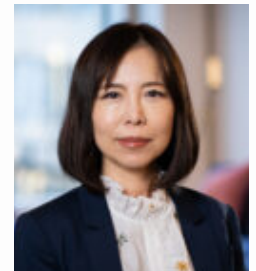

**Masae  
Ebersson**



# I will find you.

XRY Pro  
Unlock. Extract. Decode.

Investigators deserve technology that keeps pace with the devices they face. Tools that consistently extract data, even from the toughest devices. Because when you're racing against time, second chances aren't guaranteed. [www.msab.com/xryprofirst](http://www.msab.com/xryprofirst)

# MSAB



Linköping Tourist Info

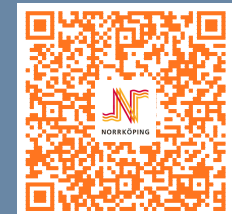

Norrköping Tourist Info